

TUERCAS REMACHABLES

ACERO / ALUMINIO / INOX A2 / INOX A4



DESCRIPCION	ACERO	ALUM.	INOX A2	INOX A4
TUERCA REMACHABLE CON CABEZA	X	X	X	X
TUERCA REMACHABLE CON CABEZA AVELLANADA	X	X	X	X
TUERCA REMACHABLE SIN CABEZA	X	X	X	
TUERCA REMACHABLE CON CABEZA CIEGA	X	X		
TUERCA REMACHABLE CON CABEZA AVELLANADA CIEGA	X			
TUERCA REMACHABLE CON CABEZA HEXAGONAL	X			
TUERCA REMACHABLE SIN CABEZA HEXAGONAL	X			
TUERCA REMACHABLE SEMIHEXAGONAL CON CABEZA	X		X	
TUERCA REMACHABLE SEMIHEXAGONAL SIN CABEZA	X		X	

TUERCA REMACHABLE ACERO CON CABEZA

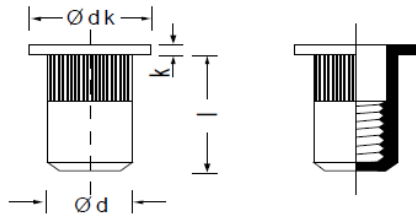

RIVET NUT FALT HEAD STEEL



CODIGO	REFERENCIA	METRICA mm 	l mm (+0.5/ -0)	ESPESOR	dk mm (+0/- 0.5)	K ≤ mm	d mm (+0/- 0.2)
00844	76100031	M3 (5.0)	10,5	0,5-2,5	7,0	0,9	4,9
00845	76100032	M3 (5,0)	11,5	2,5-4,0	7,0	0,9	4,9
00846	76100041	M4 (6,0)	11,0	0,5-3,0	9,0	1,1	5,9
00847	76100042	M4 (6,0)	14,0	3,5-5,5	9,0	1,1	5,9
00848	76100051	M5 (7,0)	13,0	0,5-3,0	10,0	1,1	6,9
00849	76100052	M5 (7,0)	16,0	3,0-5,5	10,0	1,1	6,9
00850	76100053	M5 (7,0)	19,0	5,5-8,0	10,1	1,1	6,9
00851	76100061	M6 (9.0)	16.0	0,5-3,0	12.0	1.6	8.9
00852	76100062	M6 (9.0)	18.5	3,0-5,5	12.0	1.6	8.9
00853	76100063	M6 (9.0)	21.0	5,5-8,0	12.0	1.6	8.9
00854	76100081	M8 (11.0)	17.5	0.5-3.0	15.0	1.6	10.9
00855	76100082	M8 (11.0)	20.0	3.0-5.5	15.0	1.6	10.9
00856	76100083	M8 (11.0)	22.5	5.5-8.0	15.0	1.6	10.9
00857	76100084	M8 (11.0)	25.0	8.0-10.5	15.0	1.6	10.9
00858	761000101	M10 (13.0)	19.0	0.5-3.0	16.0	2.1	11.9
00859	761000102	M10 (13.0)	24.0	3.0-6.0	16.0	2.1	11.9
00934	761000103	M10 (13.0)	27.0	6.0-9.0	16.0	2.1	11.9
00935	761000104	M10 (12.0)	30.0	9.0-12.0	16.0	2.1	11.9
00936	761000121	M12 (16.0)	25.0	1.0-4.0	22.0	2.1	15.9
00937	761000122	M12 (16.0)	28.0	4.0-7.0	22.0	2.1	15.9
00938	761000123	M12 (16.0)	31.0	7.0-10.0	22.0	2.1	15.9

DATOS MECANICOS



METRICA	 (Nm)		
M3	3,0	4.900	990
M4	4,5	7.840	1.660
M5	7,8	11.070	2.760
M6	20,0	17.640	3.430
M8	29,0	27.440	4.410
M10	32,0	29.400	4.900
M12	43,7	48.020	6.860

TUERCA REMACHABLE ACERO CON CABEZA CIEGAS-

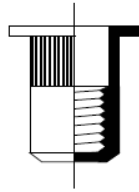
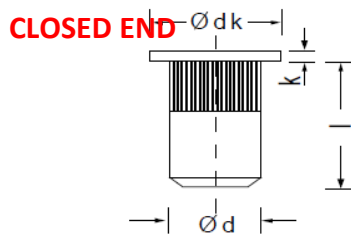

RIVET NUT FALT HEAD STEEL



CODIGO	REFERENCIA	METRICA mm 	l mm (+0.5/ -0)	ESPESOR	D2 mm (+0/- 0.5)	K ≤ mm	D1 mm (+0/- 0.2)
00940	76100131	M3 (5.0)	15.0	0,5-2,5	7,0	0,9	4,9
00941	76100132	M3 (5,0)	16.0	2,5-4,0	7,0	0,9	4,9
00942	76100141	M4 (6,0)	16,0	0,5-3,0	9,0	1,1	5,9
00943	76100142	M4 (6,0)	19,0	3,5-5,5	9,0	1,1	5,9
00944	76100151	M5 (7,0)	18,5	0,5-3,0	10,0	1,1	6,9
00945	76100152	M5 (7,0)	21,5	3,0-5,5	10,0	1,1	6,9
00946	76100153	M5 (7,0)	24,5	5,5-8,0	10,1	1,1	6,9
00947	76100161	M6 (9,0)	21.5	0,5-3,0	12,0	1.6	8.9
00948	76100162	M6 (9,0)	24.0	3,0-5,5	12,0	1.6	8.9
00949	76100163	M6 (9,0)	26.5	5,5-8,0	12,0	1.6	8.9
00950	76100181	M8 (11.0)	26.0	0.5-3.0	15.0	1.6	10.9
00951	76100182	M8 (11.0)	28.5	3.0-5.5	15.0	1.6	10.9
00952	76100183	M8 (11.0)	31.0	5.5-8.0	15.0	1.6	10.9
00953	76100184	M8 (11.0)	33.5	8.0-10.5	15.0	1.6	10.9
00954	761001101	M10 (12.0)	28.0	0.5-3.0	16.0	2.1	11.9
00955	761001102	M10 (12.0)	33.0	3.0-6.0	16.0	2.1	11.9
00956	761001103	M10 (12.0)	36.0	6.0-9.0	16.0	2.1	11.9
00957	761001104	M10 (12.0)	39.0	9.0-12.0	16.0	2.1	11.9

DATOS MECANICOS



METRICA	 (Nm)		
M3	3,0	4.900	990
M4	4,5	7.840	1.660
M5	7,8	11.070	2.760
M6	20,0	17.640	3.430
M8	29,0	27.440	4.410
M10	32,0	29.400	4.900
M12	43,7	48.020	6.860

TUERCA REMACHABLE ACERO CON CABEZA AVELLANADA - RIVET NUT COUNTERSUNK HEAD

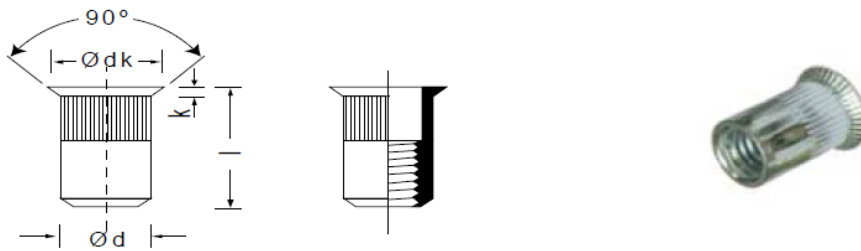

STEEL



CODIGO	REFERENCIA	METRICA mm	l mm (+0.5/ -0)	ESPESOR	dk mm (+0/- 0.5)	K ≤ mm	d mm (+0/- 0.2)
00958	76102031	M3 (5.0)	11.5	1,5-3,5	7,5	0,9	4,9
00959	76102032	M3 (5,0)	12.5	3,5-5,0	7,5	0,9	4,9
00960	76102041	M4 (6,0)	12.5	1,5-4,0	8.5	1,1	5,9
00961	76102042	M4 (6,0)	15.0	4,0-6,5	8.5	1,1	5,9
00962	76102051	M5 (7,0)	13,5	1,5-4,0	9.5	1,1	6,9
00963	76102052	M5 (7,0)	16.0	4,0-6,5	9.5	1,1	6,9
00964	76102053	M5 (7,0)	18,5	6,5-9,0	9.5	1,1	6,9
00965	76102061	M6 (9.0)	15.5	1,5-4,0	11.5	1.6	8.9
00966	76102062	M6 (9.0)	18.0	4,0-6,5	11.5	1.6	8.9
00967	76102063	M6 (9.0)	20.0	6,5-9,0	11.5	1.6	8.9
00968	76102081	M8 (11.0)	18.5	1.5-4.0	13.5	1.6	10.9
00969	76102082	M8 (11.0)	21.0	4.0-6.5	13.5	1.6	10.9
00970	76102083	M8 (11.0)	23.5	6.5-9.0	13.5	1.6	10.9
00971	761020101	M10 (12.0)	21.0	2.0-4.5	14.5	1.7	11.9
00972	761020102	M10 (12.0)	24.0	4.5-7.5	14.5	1.7	11.9
00973	761020103	M10 (12.0)	27.0	7.5-10.5	14.5	1.7	11.9
00974	761020121	M12 (16.0)	24.5	2.0-4.5	19.0	1.9	15.9
00975	761020122	M12 (16.0)	27.5	4.5-7.5	19.0	1.9	15.9
00976	761020123	M12 (16.0)	31.0	7.5-10.5	19.0	1.9	15.9

DATOS MECANICOS



METRICA	 (Nm)		
M3	3,0	4.900	990
M4	4,5	7.840	1.660
M5	7,8	11.070	2.760
M6	20,0	17.640	3.430
M8	29,0	27.440	4.410
M10	32,0	29.400	4.900
M12	43,7	48.020	6.860

TUERCA REMACHABLE ACERO CON CABEZA AVELLANADA CIEGA – RIVET NUT COUNTERSUNK HEAD STEEL CLOSED

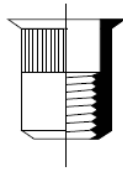
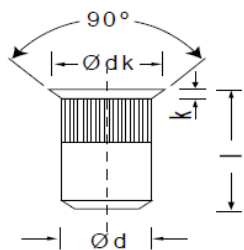

END



CODIGO	REFERENCIA	METRICA mm 	l mm (+0.5/ -0)	ESPEJOR	dk mm (+0/- 0.5)	K ≤ mm	d mm (+0/- 0.2)
00977	76102131	M3 (5.0)	16.0	1,5-3,5	7,5	0,9	4,9
00978	76102132	M3 (5.0)	17.0	3,5-5,0	7,5	0,9	4,9
00979	76102141	M4 (6.0)	17.5	1,5-4,0	8.5	1,1	5,9
00980	76102142	M4 (6.0)	20.0	4,0-6,5	8.5	1,1	5,9
00981	76102151	M5 (7.0)	20.0	1,5-4,0	9.5	1,1	6,9
00982	76102152	M5 (7.0)	22.5	4,0-6,5	9.5	1,1	6,9
00983	76102153	M5 (7.0)	25.0	6,5-9,0	9.5	1,1	6,9
00984	76102161	M6 (9.0)	23.0	1,5-4,0	11.5	1.6	8.9
00985	76102162	M6 (9.0)	25.5	4,0-6,5	11.5	1.6	8.9
00986	76102163	M6 (9.0)	28.0	6,5-9,0	11.5	1.6	8.9
00987	76102181	M8 (11.0)	27.0	1.5-4.0	13.5	1.6	10.9
00988	76102182	M8 (11.0)	29.5	4.0-6.5	13.5	1.6	10.9
00989	76102183	M8 (11.0)	32.0	6.5-9.0	13.5	1.6	10.9
00990	761021101	M10 (13.0)	30.0	2.0-4.5	14.5	1.7	11.9
00991	761021102	M10 (13.0)	33.0	4.5-7.5	14.5	1.7	11.9
00992	761021103	M10 (13.0)	36.0	7.5-10.5	14.5	1.7	11.9
00993	761021121	M12 (16.0)	34.5	2.0-4.5	19.0	1.9	15.9
00994	761021122	M12 (16.0)	37.5	4.5-7.5	19.0	1.9	15.9
00995	761021123	M12 (16.0)	40.5	7.5-10.5	19.0	1.9	15.9

DATOS MECANICOS



METRICA	 (Nm)		
M3	3,0	4.900	990
M4	4,5	7.840	1.660
M5	7,8	11.070	2.760
M6	20,0	17.640	3.430
M8	29,0	27.440	4.410
M10	32,0	29.400	4.900
M12	43,7	48.020	6.860

TUERCA REMACHABLE ACERO SIN CABEZA

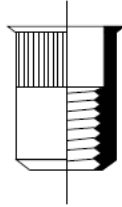
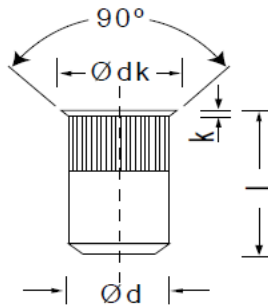

RIVET NUT REDUCED HEAD STEEL



CODIGO	REFERENCIA	METRICA mm	l mm (+0.5/ -0)	ESPESOR	dk mm (+0/- 0.5)	K ≤ mm	d mm (+0/- 0.2)
00996	76103031	M3 (5.0)	9,5	0,5-2,5	6,0	0,7	4,9
00997	76103041	M4 (6.0)	10,0	0,5-3,0	7,0	0,7	5,9
00998	76103051	M5 (7.0)	11,5	0,5-3,0	8,0	0,7	6,9
00999	76103061	M6 (9.0)	14,0	0,5-3,0	10,0	0,7	8,9
01000	76103081	M8 (11.0)	15,5	0,5-3,0	12,0	0,7	10,9
01001	76103010	M10(12.0)	19,5	0,8-3,5	13,5	0,9	11,9

DATOS MECANICOS



METRICA	 (Nm)		
M3	3,0	3.900	900
M4	4,0	6.470	1.620
M5	5,0	9.090	2.190
M6	15,0	16.660	2.350
M8	18,0	21.610	2.840
M10	30,5	31.750	4.260

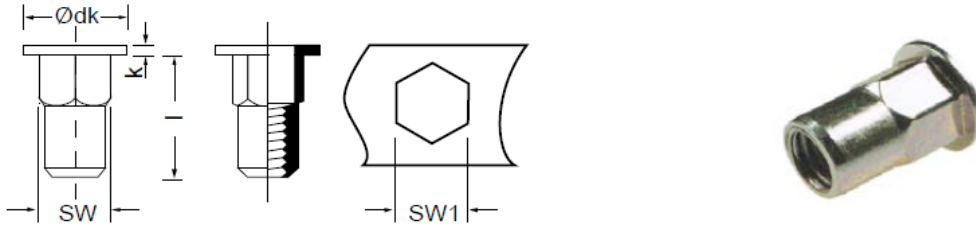

TUERCA REMACHABLE ACERO CON CABEZA SEMIHEXAGONAL - RIVET NUT FLAT HEAD STEEL SEMI-HEX



CODIGO	REFERENCIA	METRICA mm 	l mm (+0.5/ -0)	ESPEJOR	dk mm (+0/- 0.5)	K ≤ mm	d mm (+0/- 0.2)
01002	76140041	M4 (7.1)	13.0	0.5-3.0	9.5	1.1	6.0
01003	76140051	M5 (7.1)	14.5	0.5-3.0	10.5	1.1	7.0
01004	76140061	M6 (9.1)	17.0	0.5-3.0	12.5	1.6	14.0
01005	76140081	M8 (11.1)	19.0	0.5-3.0	14.5	1.6	22.0
01006	76140010	M10 (13.1)	24.0	0.8-4.0	16.5	2.1	35.0

DATOS MECANICOS

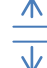

METRICA	 (Nm)		
M4	5.0	4.900	3.400
M5	7.0	8.800	1.900
M6	14.0	16.600	2.900
M8	22.0	21.500	3.000
M10	35.0	29.400	3.400

TUERCA REMACHABLE ACERO SIN CABEZA SEMIHEXAGONAL - RIVET NUT REDUCED HEAD STEEL

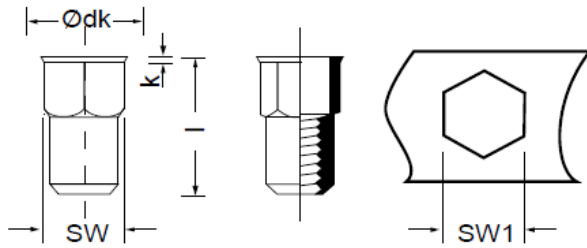

SE



CODIGO	REFERENCIA	METRICA mm 	l mm (+0.5/ -0)	ESPEJOR	dk mm (+0/- 0.5)	K ≤ mm	sw mm (+0/- 0.2)
01007	76143031	M3 (5.1)	10,5	0,5-2,5	6,5	0,8	5,0
01008	76143041	M4 (6.1)	12,5	0,5-3,0	7,0	0,8	6,0
01009	76143051	M5 (7.1)	14,0	0,5-3,0	8,0	0,8	7,0
01010	76143061	M6 (9.1)	16,0	0,5-3,0	10,0	0,8	9,0
01011	76143081	M8 (11.1)	17,0	0,5-3,0	12,0	0,8	11,0
01012	76143010	M10(13.1)	20,5	0,8-4,0	14,5	0,8	13,0

DATOS MECANICOS



METRICA	 (Nm)		
M4	3,0	2.900	900
M5	5,0	3.530	1.470
M6	7,0	4.900	1.760
M7	14,0	14.700	2.940
M8	21,0	21.560	3.020
M10	35,0	29.400	3.400

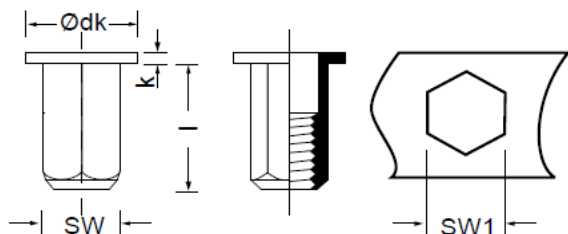

TUERCA REMACHABLE ACERO CON CABEZA HEXAGONAL

HEXAGONAL - RIVET NUT FLAT HEAD STEEL HEXAGON BODY





CODIGO	REFERENCIA	METRICA mm 	l mm (+0.5/-0)	ESPESOR	dk mm (+0/-0.5)	K ≤ mm	sw mm (+0/-0.2)
01013	76150041	M4 (7.1)	13,0	0,5-3,0	9,5	1,1	6,0
01014	76150051	M5 (7.1)	14,5	0,5-3,0	10,5	1,1	7,0
01015	76150061	M6 (9.1)	17,0	0,5-3,0	12,5	1,6	9,0
01016	76150081	M8 (11.1)	19,0	0,5-3,0	14,5	1,6	11,0
01017	76150010	M10(13.1)	24,0	0,8-4,0	16,5	2,1	13,0

DATOS MECANICOS →

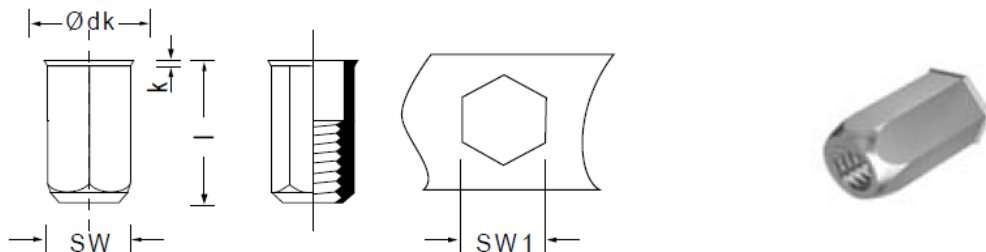

METRICA	 (Nm)		
M4	5,0	4.900	3.400
M5	7,0	8.800	1.900
M6	14,0	16.600	2.900
M8	22,0	21.500	3.000
M10	35,0	29.400	3.400

TUERCA REMACHABLE ACERO SIN CABEZA HEXAGONAL — RIVET NUT REDUCED HEAD STEEL HEXAGON BODY



CODIGO	REFERENCIA	METRICA mm 	l mm (+0.5/ -0)	ESPESOR	DK mm (+0/-0.5)	K ≤ mm	SW mm (+0/- 0.2)
01018	76153041	M4 (7.1)	13,0	0,5-3,0	9,5	1,1	6,0
01019	76153051	M5 (7.1)	14,5	0,5-3,0	10,5	1,1	7,0
01020	76153061	M6 (9.1)	17,0	0,5-3,0	12,5	1,6	9,0
01021	76153081	M8 (11.1)	19,0	0,5-3,0	14,5	1,6	11,0
01022	76153010	M10(13.1)	24,0	0,8-4,0	16,5	2,1	13,0

DATOS MECANICOS

METRICA	 (Nm)		
M4	5,0	4.900	3.400
M5	7,0	8.800	1.900
M6	14,0	16.600	2.900
M8	22,0	21.500	3.000
M10	35,0	29.400	3.400

TUERCA REMACHABLE INOX CON CABEZA

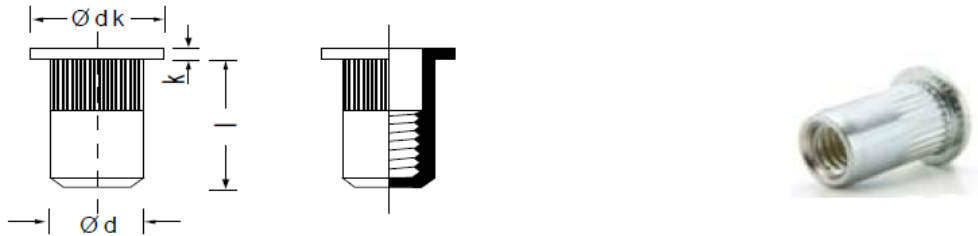

RIVET NUT FLAT HEAD STAINLESS

STEEL

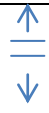

CODIGO	REFERENCIA	METRICA mm 	l mm (+0.5/ -0)	ESPESOR	Dk mm (+0/- 0.5)	K ≤ mm	d mm (+0/-0.2)
01023	76200041	M4 (6.0)	11.0	0.5-3.0	9.0	1.1	5.9
01024	76200042	M4 (6.0)	14.0	3.0-4.5	9.0	1.1	5.9
01025	76200051	M5 (7.0)	13.0	0.5-3.0	10.0	1.1	6.9
01026	76200052	M5 (7.0)	16.0	3.0-5.5	10.0	1.1	6.9
01027	76200053	M5 (7.0)	19.0	5.5-8.0	10.0	1.1	6.9
01028	76200061	M6 (9.0)	16.0	0.5-3.0	12.0	1.6	8.9
01029	76200062	M6 (9.0)	18.5	3.0-5.5	12.0	1.6	8.9
01030	76200081	M8 (11.0)	17.5	0.5-3.0	15.0	1.6	10.9
01031	76200082	M8 (11.0)	20.0	3.0-5.5	15.0	1.6	10.9
01032	762000101	M10(13.0)	19.0	0.5-3.0	16.0	2.1	12.9
01033	762000102	M10(13.0)	24.0	3.0-6.0	16.0	2.1	12.9

DATOS MECANICOS

METRICA	 (Nm)		
M4	7.0	7.800	2.600
M5	12.0	11.760	3.920
M6	22.2	20.580	5.630
M8	30.5	26.460	7.800
M10	39.0	35.280	8.800

*TAMBIEN DISPONIBLES EN CIEGAS

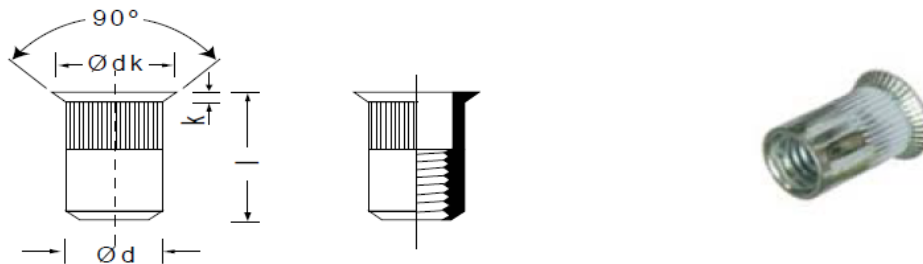

TUERCA REMACHABLE INOX CON CABEZA AVELLANADA — RIVET NUT COUNTERSUNK HEAD STAINLESS

STAINLESS



CODIGO	REFERENCIA	METRICA mm 	l mm (+0.5/-0)	ESPESOR	dk mm (+0/-0.5)	K ≤ mm	d mm (+0/-0.2)
01034	76202031	M3 (5.0)	11.5	1.5-3.5	7.5	1.5	4.9
01035	76202032	M3 (5.0)	12.5	3.5-4.5	7.5	1.5	4.9
01036	76202041	M4 (6.0)	12.5	1.5-4.0	8.5	1.5	5.9
01037	76202051	M5 (7.0)	13.0	1.5-4.0	9.5	1.5	6.9
01038	76202052	M5 (7.0)	16.0	4.0-6.5	9.5	1.5	6.9
01039	76202061	M6 (9.0)	15.5	1.5-4.0	11.5	1.5	8.9
01040	76202062	M6 (9.0)	18.0	4.0-6.5	11.5	1.5	8.9
01041	76202081	M8 (11.0)	18.5	1.5-4.0	13.5	1.5	10.9
01042	76202082	M8 (11.0)	21.0	4.0-6.5	13.5	1.5	10.9
01043	762020101	M10(13.0)	21.0	2.0-4.5	15.5	1.8	12.9
01044	762020102	M10(13.0)	24.0	4.5-7.5	15.5	1.8	12.9
01045	762020121	M12(16.0)	24.5	2.0-4.5	19.0	2.0	15.9
01046	762020122	M12(16.0)	27.5	4.5-7.5	19.0	2.0	15.9

DATOS MECANICOS

METRICA	 (Nm)		
M3	3.5	5.800	1.400
M4	9.0	10.130	3.720
M5	10.5	12.250	4.020
M6	21.0	20.580	5.560
M8	31.0	30.840	7.640
M10	33.0	34.300	8.110
M12	50.0	59.900	9.800

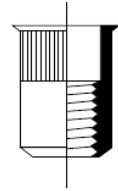
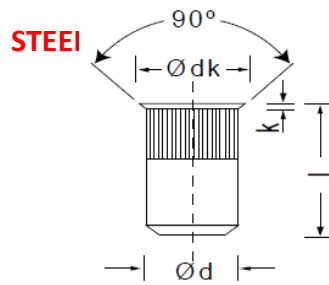

TUERCA REMACHABLE INOX SIN CABEZA

RIVET NUT REDUCED COUNTERSUNK STAINLEES





CODIGO	REFERENCIA	METRICA mm 	l mm (+0.5/ -0)	ESPESOR	dk mm (+0/ -0.5)	K ≤ mm	d mm (+0/-0.2)
01047	76203041	M4 (6.0)	10.0	0-5.2.5	7.0	0.9	5.9
01048	76203051	M5 (7.0)	11.5	0.5-3.0	8.0	0.9	6.9
01049	76203061	M6 (9.0)	14.0	0.5-3.0	10.0	0.9	8.9
01050	76203081	M8 (11.0)	15.5	0.5-3.0	12.0	0.9	10.9
01051	76203010	M10(13.0)	19.5	0.8-3.5	14.5	1.1	12.9

DATOS MECANICOS

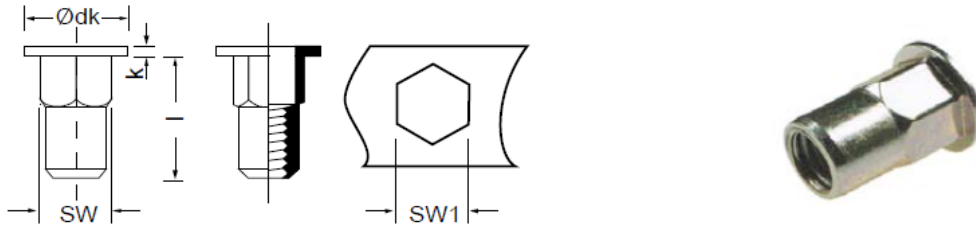

METRICA	 (Nm)		
M4	9.0	9.860	2.940
M5	10.5	11.760	4.030
M6	21.0	18.620	5.230
M8	31.0	25.480	5.400
M10	32.0	33.320	5.880

TUERCA REMACHABLE INOX CON CABEZA SEMIHEXAGONAL - RIVET NUT FLAT HEAD STAINLESS STEEL SEMI-HEX.





CODIGO	REFERENCIA	METRICA mm 	l mm (+0.5/ -0)	ESPESOR	dk mm (+0/ -0.5)	K ≤ mm	SW mm (+0/-0.2)
01052	76240041	M4 (6.1)	11.5	0.5-2.5	9.3	1.1	6.0
01053	76240051	M5 (7.1)	13.5	0.5-3.0	10.3	1.1	7.0
01054	76240061	M6 (9.1)	15.5	0.5-3.0	12.3	1.6	9.0
01055	76240081	M8 (11.1)	17.5	0.5-3.0	14.3	1.6	11.0
01056	76240010	M10(13.1)	24.0	0.8-4.0	16.3	2.1	13.0

DATOS MECANICOS →

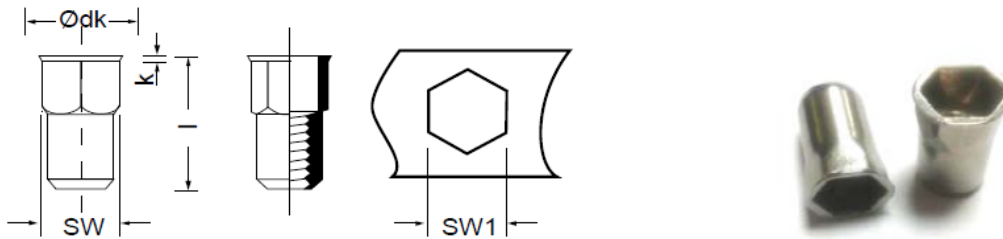

METRICA	 (Nm)		
M4	12.0	10.190	2.680
M5	14.0	12.740	3.430
M6	26.0	19.600	4.700
M8	39.0	37.420	6.680
M10	45.0	63.700	7.840

TUERCA REMACHABLE INOX SIN CABEZA SEMIHEXAGONAL — RIVET NUT REDUCED HEAD STAINLESS STEEL SEMI-HEX.



CODIGO	REFERENCIA	METRICA mm 	l mm (+0.5/ -0)	ESPEJOR	dk mm (+0/- 0.5)	K ≤ mm	SW mm (+0/-0.2)
01057	76243041	M4 (6.0)	12.5	0.5-2.5	7.0	0.9	6.0
01058	76243051	M5 (7.0)	14.0	0.5-3.0	8.0	0.9	7.0
01059	76243061	M6 (9.0)	16.0	0.5-3.0	10.0	0.9	9.0
01060	76243081	M8 (11.0)	17.0	0.5-3.0	12.0	0.9	11.0
01061	76243010	M10(13.0)	20.5	0.8-4.0	14.5	1.1	13.0

DATOS MECANICOS →

METRICA	 (Nm)		
M4	12.0	8.240	2.950
M5	12.0	11.760	2.950
M6	21.0	21.560	3.820
M8	30.0	24.500	3.920
M10	40.0	47.040	5.010

TUERCA REMACHABLE INOX A4 CON CABEZA

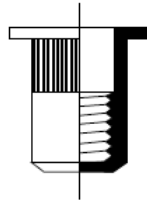
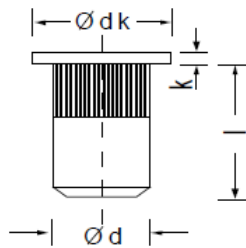

RIVET NUT FLAT HEAD STAINLESS STEEL A4



CODIGO	REFERENCIA	METRICA mm 	l mm (+0/ -1.3)	ESPESOR	Dk mm (+0/ -0.6)	K ≤ mm	d mm (+0/ -0.2)
01062	76300051	M5 (7,0)	13,0	0,5-3,0	10,0	1,1	6,9
01063	76300061	M6 (9,0)	16,0	0,5-3,0	12,0	1,6	8,9
01064	76300081	M8 (11,0)	17,5	0,5-3,0	15,0	1,6	10,9

DATOS MECANICOS



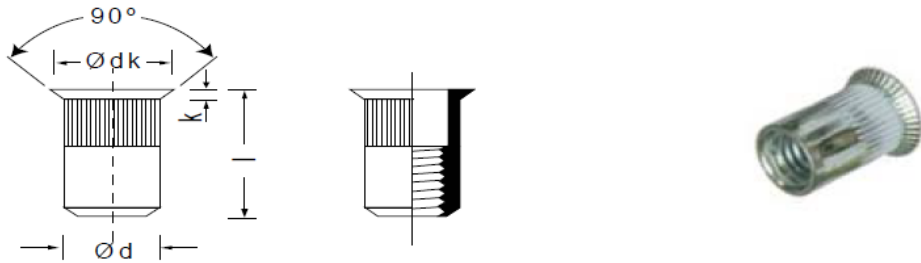

METRICA	 (Nm)		
M5	12.00	11.760	3.920
M6	22.2	20.580	5.630
M8	30,5	26.460	7.800

TUERCA REMACHABLE INOX A4 CABEZA AVELLANDA — RIVET NUT COUNTERSUNK HEAD STAINLESS STEEL A4



CODIGO	REFERENCIA	METRICA mm 	l mm (+0/-1.3)	ESPESOR	dk mm (+0/-0.6)	K mm	dmm (+0/-0.2)
01065	76302061	M5 (7,0)	13,5	1,5-4,0	10,0	1,5	6,9
01066	76302061	M6 (9,0)	15,5	1,5-4,0	12,0	1,5	8,9
01067	76302081	M8(11,0)	18,5	1,5-4,0	15,0	1,5	10,9

DATOS MECANICOS →

METRICA	 (Nm)		
M5	10.5	12.250	4.020
M6	21.0	20.580	5.560
M8	31,0	30.840	7.640

TUERCA REMACHABLE ALUMINIO CON CABEZA

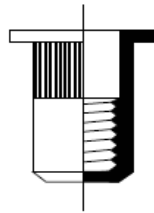
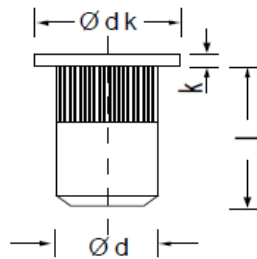



RIVET NUT FLAT HEAD ALUMINUM



CODIGO	REFERENCIA	METRICA mm 	l mm (+0.5/-0)	ESPESOR	DKmm (+0/-0.5)	K ≤ mm	d mm (+0/-0.2)
01068	76400031	M3 (5.0)	10.5	0.5-2.5	7,0	0,9	4,9
01069	76400032	M3 (5,0)	11.5	2.5-3.5	7,0	0,9	4,9
01070	76400041	M4 (6,0)	11.0	0.5-3.0	9.0	1,1	5,9
01071	76400042	M4 (6,0)	14.0	3.0-4.5	9.0	1,1	5,9
01072	76400051	M5 (7,0)	13.0	0.5-3.0	10.0	1,1	6,9
01073	76400052	M5 (7,0)	16.0	3.0-5.5	10.0	1,1	6,9
01074	76400053	M5 (7,0)	19.0	5.5-8.8	10.0	1,1	6,9
01075	76400061	M6 (9.0)	16.0	0.5-3.0	12.0	1.6	8.9
01076	76400062	M6 (9.0)	18.5	3.0-5.5	12.0	1.6	8.9
01077	76400063	M6 (9.0)	21.0	5.5-8.8	12.0	1.6	8.9
01078	76400081	M8 (11.0)	17.5	0.5-3.0	15.0	1.6	10.9
01079	76400082	M8 (11.0)	20.0	3.0-5.5	15.0	1.6	10.9
01080	76400083	M8 (11.0)	22.5	5.5-8.0	15.0	1.6	10.9
01081	76400084	M8 (11.0)	25.0	8.0-10.5	15.0	1.6	10.9
01082	764000101	M10 (12.0)	19.0	0.8-3.0	16.0	2.1	11.9
01083	764000102	M10 (12.0)	24.0	3.0-6.0	16.0	2.1	11.9
01084	764000103	M10 (12.0)	27.0	6.0-9.0	16.0	2.1	11.9
01085	764000104	M10 (12.0)	30.0	9.0-12.0	16.0	2.1	11.9
01086	764000121	M12 (16.0)	25.0	1.0-4.0	22.0	2.1	15.9
01087	764000122	M12 (16.0)	28.0	4.0-7.0	22.0	2.1	15.9
01088	764000123	M12 (16.0)	31.0	7.0-10.0	22.0	2.1	15.9

DATOS MECANICOS



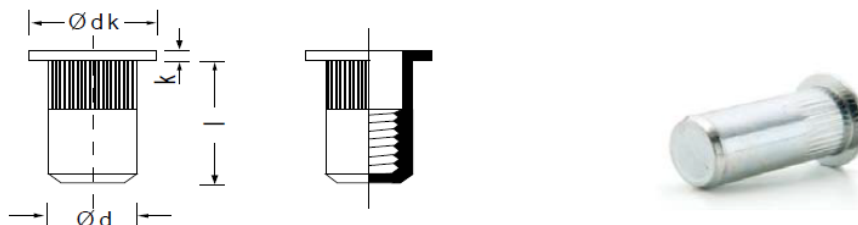

METRICA	 (Nm)		
M3	2,0	2.000	700
M4	4,0	2.840	1.070
M5	5,0	4.900	1.170
M6	14,6	9.300	2.280
M8	14,6	14.750	2.450
M10	20,0	21.500	3.820
M12	23,0	27.400	4.400

TUERCA REMACHABLE ALUMINIO CON CABEZA CIEGAS — RIVET NUT FLAT HEAD ALLUMINIUM CLOSED END





CODIGO	REFERENCIA	METRICA mm 	l mm (+0.5/-0)	ESPESOR	D2 mm (+0/-0.5)	K ≤ mm	D1 mm (+0/-0.2)
01089	76400131	M3 (5.0)	15.0	0,5-2,5	7,0	0,9	4,9
01090	76400132	M3 (5,0)	16.0	2,5-3.5	7,0	0,9	4,9
01091	76400141	M4 (6,0)	16,0	0,5-3,0	9,0	1,1	5,9
01092	76400142	M4 (6,0)	19,0	3,5-4,5	9,0	1,1	5,9
01093	76400151	M5 (7,0)	18,5	0,5-3,0	10,0	1,1	6,9
01094	76400152	M5 (7,0)	21,5	3,0-5,5	10,0	1,1	6,9
01095	76400153	M5 (7,0)	24,5	5,5-8,0	10,1	1,1	6,9
01096	76400161	M6 (9,0)	21.5	0,5-3,0	12.0	1.6	8.9
01097	76400162	M6 (9,0)	24.0	3,0-5,5	12.0	1.6	8.9
01098	76400163	M6 (9,0)	26.5	5,5-8,0	12.0	1.6	8.9
01099	76400181	M8 (11.0)	26.0	0.5-3.0	15.0	1.6	10.9
01100	76400182	M8 (11.0)	28.5	3.0-5.5	15.0	1.6	10.9
01101	76400183	M8 (11.0)	31.5	5.5-8.0	15.0	1.6	10.9
01102	76400184	M8 (11.0)	33.5	8.0-10.5	15.0	1.6	10.9
01103	764001101	M10 (12.0)	28.0	0.5-3.0	16.0	2.1	11.9
01104	764001102	M10 (12.0)	33.0	3.0-6.0	16.0	2.1	11.9
01105	764001103	M10 (12.0)	36.0	6.0-9.0	16.0	2.1	11.9
01106	764001104	M10 (12.0)	39.0	9.0-12.0	16.0	2.1	11.9

DATOS MECANICOS →

METRICA	 (Nm)		
M3	2,0	2.000	700
M4	4,0	2.800	1.000
M5	5,0	4.900	1.100
M6	11,0	9.300	2.200
M8	14,6	14.700	2.400
M10	19,9	21.500	3.800

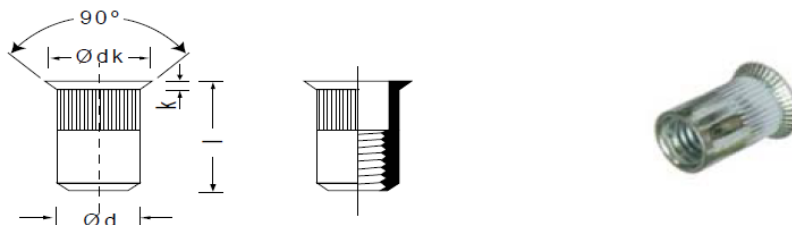

TUERCA REMACHABLE ALUMINIO CABEZA AVELLANADA — RIVET NUT COUNTERSUN ALLUMINIUM



CODIGO	REFERENCIA	METRICA mm 	l mm (+0.5/ -0)	ESPESOR	dk mm (+0.2/ -0.5)	K ≤ mm	d mm (+0/ -0.2)
01107	76402031	M3 (5.0)	11,5	1,5-3,5	7,5	1,5	4,9
01108	76402032	M3 (5.0)	12,5	3,5-4,5	7,5	1,5	4,9
01109	76402041	M4 (6.0)	12,5	1,5-4,0	8,5	1,5	5,9
01110	76402042	M4 (6.0)	15,0	4,0-5,5	8,5	1,5	5,9
01111	76402051	M5 (7.0)	13,5	1,5-4,0	9,5	1,5	6,9
01112	76402052	M5 (7.0)	16,0	4,0-6,5	9,5	1,5	6,9
01113	76402053	M5 (7.0)	18,5	6,5-9,0	9,5	1,5	6,9
01114	76402061	M6 (9.0)	15,5	1,5-4,0	11,5	1,5	8,9
01115	76402032	M6 (9.0)	18,0	4,0-6,5	11,5	1,5	8,9
01116	76402063	M6 (9.0)	20,5	6,5-9,0	11,5	1,5	8,9
01117	76402081	M8 (11.0)	18,5	1,5-4,0	13,5	1,5	10,9
01118	76402082	M8 (11.0)	21,0	4,0-6,5	13,5	1,5	10,9
01119	76402083	M8 (11.0)	23,5	6,5-9,0	13,5	1,5	10,9
01120	764020101	M10(12.0)	21.0	2.5-4.5	14.5	1.7	11.9
01121	764020102	M10(12.0)	24.0	4.5-7.5	14.5	1.7	11.9
01122	764020103	M10(12.0)	27.0	7.5-10.5	14.5	1.7	11.9
01123	764020121	M12(16.0)	24.5	2.5-4.5	19.0	1.9	15.9
01124	764020122	M12(16.0)	27.5	4.5-7.5	19.0	1.9	15.9
00125	764020123	M12(16.0)	31.0	7.5-10.5	19.0	1.9	15.9

DATOS MECANICOS



METRICA	 (Nm)		
M3	2,0	2.000	700
M4	4,0	2.840	1.070
M5	5,0	4.900	1.170
M6	11,3	9.300	2.280
M8	14,6	14.700	2.400
M10	20,0	21.500	3.820
M12	23,0	27.400	4.400

TUERCA REMACHABLE ALUMINIO SIN CABEZA

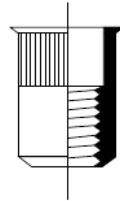
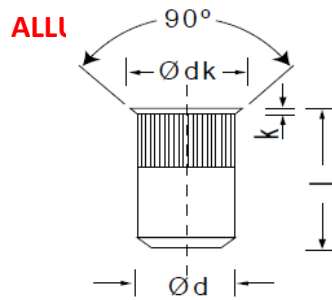

RIVET NUT REDUCED COUNTERSUNK



CODIGO	REFERENCIA	METRICA mm 	l mm (+0.5/-0)	ESPESOR	dk mm (+0/-0.5)	K ≤ mm	d mm (+0/-0.2)
01126	76403031	M3 (5.0)	9,5	0,5-2,5	6,0	0,7	4,9
01127	76403041	M4 (6.0)	10,0	0,5-3,0	7,0	0,7	5,9
01128	76403051	M5 (7.0)	11,5	0,5-3,0	8,0	0,7	6,9
01129	76403061	M6 (9.0)	14,0	0,5-3,0	10,0	0,7	8,9
01130	76403081	M8 (11.0)	15,5	0,5-3,0	12,0	0,7	10,9

DATOS MECANICOS



METRICA	 (Nm)		
M3	2,0	1.700	700
M4	4,0	2.840	1.080
M5	4,5	5.250	1.180
M6	9,6	9.680	1.960
M8	10,9	15.680	2.060